

## NUCEDAR FUNDAMENTALS

1. Allow the clapboard to expand and contract. NuCedar, like all PVC products, will expand and contract with changes in temperature (e.g. 5/8" for every 16' with 100°F change).
2. NuCedar Classic Clapboard requires use of the NuCedar Universal Trim and Corner System.
3. NuCedar clapboard is installed PRIOR to installation of trim.
4. Never butt clapboard to Standard Trim.
5. Use a story board to ensure clapboards are seated properly, by cutting a piece of Snap-In Insert™ that covers three courses.
6. Use an expansion joint on runs exceeding 40ft.
7. Do not nail through trimboard expansion channel.
8. Never pin the clapboard. Never face-nail. Never caulk.
9. Cut NuCedar products using standard woodworking tools and practices.
10. We Recommend to install in temperatures over 40 degrees. If installing under 40 degrees, keep adhesive warm until ready to use.
11. Plan your layout prior to installation.
12. Colors with light reflective value (LRV) of less than 25 are not recommended with NuCedar Products.

## STORAGE AND HANDLING

Store NuCedar products in the shade and on a flat surface. Product should be carried on edge by two people to minimize damage. Do not store NuCedar in any location where ambient temperatures may exceed 120°F (e.g. on blacktop pavement, under dark tarps, etc.)

Our coating is not fully cured for 30 to 90 days. Our Baked on Finish allows the product to be handled and installed, but not to be abused. Please do not drag or scratch anything along the material.

## PREPARATION

Apply NuCedar products over a properly installed weather resistant barrier system (ex. House Wrap) and ensure all wall openings and penetrations are properly flashed in accordance with local building codes and window/door manufacturer's flashing recommendations. The NuCedar cladding system is not a water-tight barrier. It is designed to reduce the amount of water that reaches the underlying weather resistant barrier.

Determine that the framing is true and without excessive bowing. Do not install NuCedar over open framing. Install clapboard over solid sheathing (ex. Plywood or OSB). NuCedar Classic Clapboard cannot be installed over furring strips.

## GENERAL INSTALLATION: CLAPBOARD

NOTE: Install clapboard PRIOR to installation of trim. Plan your layout before installation.

**Step 1: Snap Vertical Chalk Lines.** Use Chalk Line Mark on Universal Trim and Corners to establish vertical chalk lines (see Fig. 1). Vertical chalk lines provide a reference for the clapboard ends behind the trim.

**Step 2: Install Aluminum Starter Strip.** Snap a level chalk line (see Fig. 1) and fasten Starter Strip to wall every 8" and to every available stud. Fasten Aluminum Starter Strip tight to the wall. Use hot dipped galvanized roofing nails or exterior grade ring shank nails not less than 1-1/4" long. Keep the Starter Strip 1/2" away from all trim and leave 1/4" gap between joined Starter Strips.

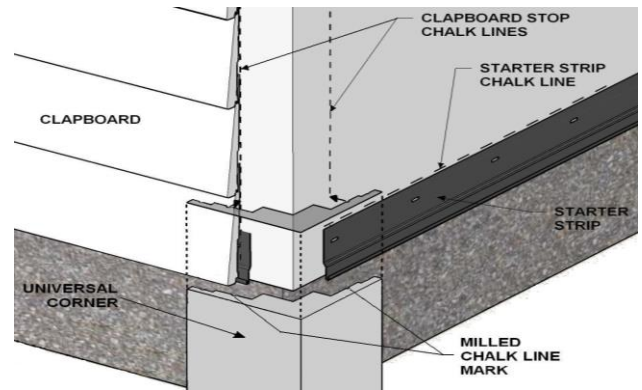

Fig. 1

**Step 3: Install Clapboard.** Insert the first course of the clapboard into the Starter Strip. Align one end of the clapboard with a vertical chalk line (see Fig. 1). For installation with temperatures of 85° or higher, extend the Clapboard end 1/4" past the chalk line. For installations with temperatures of 50° or lower, position the Clapboard end 1/4" short of the chalk line.

Attach Z-Clips™ to the top of the clapboard and position each Z-Clip™ evenly across two studs. Hand-nail Z-Clip™ into both studs with hot dipped galvanized roofing nails or exterior grade ring shank nails not less than 1-1/4" long (see Fig. 2). At least 3 nails should be used per 22" Z-Clip™. Do not overdrive your nails into the Z-Clip™, the Clapboard needs to be able to move freely, if the Z-Clip™ is indented then it will cause Clapboard to buckle. Cut a piece of Snap-In Insert™ that covers approximately three courses, and use as a story board to ensure clapboards are seated properly.

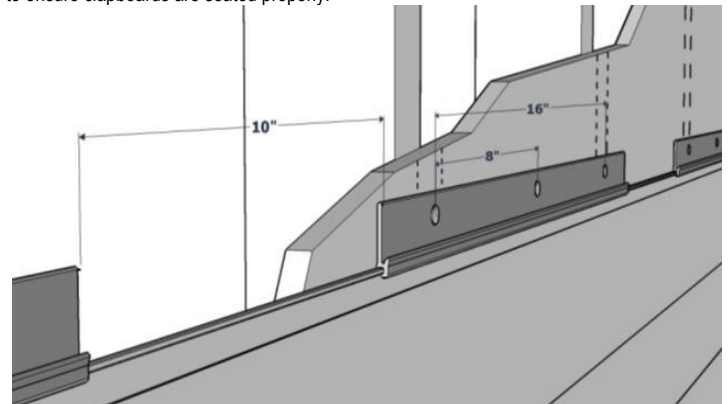

Fig. 2

If Clapboard material must be removed for the top course, use a rabbeted trimboard to hold the clapboard in place (see Fig. 7). Never face-nail clapboard.

### Step 4: Butt Joints.

**Use 1 Universal Bonding Plate on 4" Clapboard and 2 on 6" and 8" Clapboard.**

1. Plan your layout prior to installation.
2. Stagger butt joints and avoid placing joints at the bottom or top of windows or doors.
3. Square cut ends of clapboard at butt joints. Our ends are factory ends and may not be completely square. Apply supplied touch up paint on cut ends.
4. Position clapboards on the wall with butt ends tight.
5. Fasten clips to the wall leaving 24" on each end of butt joint temporarily unattached.
6. Clips should be installed over any Butt Joints.

Continued on Page 2

**Installation must follow the instructions in this manual to maintain product warranty.**

**In order to secure your warranty, please visit our website to register your product. [www.nucedar.com/technical/warranty/](http://www.nucedar.com/technical/warranty/)**

*For additional copies and revisions, go to [www.nucedar.com](http://www.nucedar.com).*

## Step 4: Butt Joints Continued.

7. Apply a thick coating of Trim Welder to the whole universal bonding plate (UBP) and mix with provided stir stick to consistent color.
8. A single tube of Trim Welder should bond five butt joints.
9. Pull butted clapboards away from the wall.
10. Insert the cemented UBP behind the joint centered between the clapboards (See Fig. 3).
11. Apply pressure for at least one minute to the butt joint area ensuring a secure bond.
12. Fasten remaining clips nearest to butt joint.
13. Failure to follow the above instructions may result in butt joint failure which is not covered under NuCedar warranty.

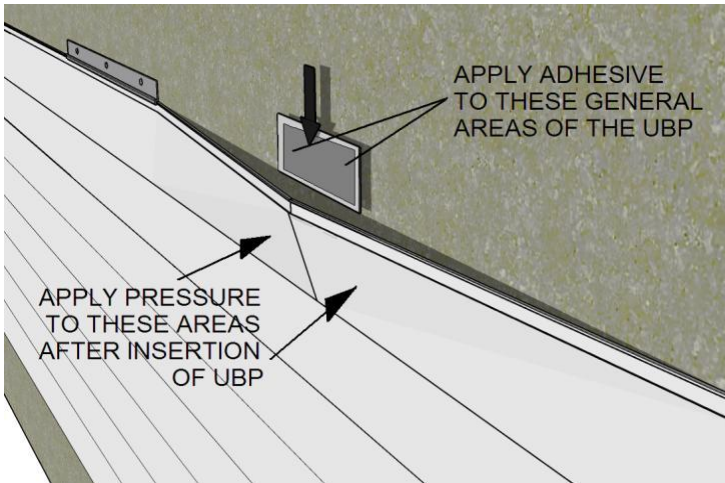

Fig. 3

## GENERAL INSTALLATION: TRIM AND CORNERS

Universal Trim and Corners are required for the NuCedar Classic Clapboard System.

Fasten trim using the recommended schedule:

- Along the length: no farther apart than 12", no more than 2" from end of board
- Along the width: no farther apart than 4"
- Do not nail through trimboard expansion channel

The preferred method of fastening is to use the Cortex hidden screw and color matching plug fastening system available through NuCedar or use exterior grade nails (6, 8, 10) or screws (6, 8). In temperatures below 40°F, pre-drilling of nail holes may be necessary to avoid cracking.

Leave approximately 1/16" space between butted ends. For installations below 50°F, increase to 1/8".

For long runs of trim, a scarf joint will provide the best looking joint that allows for expansion and contraction. Use Fill & Flex caulk in the joint. The joint should be secured with fasteners on each side of the joint.

**Universal Trim and Corners** have an expansion channel for the clapboard and are used vertically as outside corners or side window casings. Universal Trim/Corners can be used with or without Snap-In Inserts™ (see Fig. 5). For inside corners, use two pieces of Universal Trim and miter the joints together and seal the joint with adhesive. Universal Trim can also be used diagonally for rakes (without Snap-In Inserts™).

**Standard Trim** ( or square edge trim) is suggested for use as fascia, soffit, frieze, etc.). Never butt clapboard to standard trim.

**Header Trim** is suggested for use at the top of windows/doors (see Fig 8).

**Snap-In Inserts™** are only used with Universal Trim and Corners (see Fig. 5). After the trim has been installed, align the Snap-In Insert™ with the clapboard and cut to proper length. Next, apply a small dollop of Fill & Flex every two feet or so to only the side of the insert facing the Universal trim or Corner (as shown in Fig. 6) along the entire length of the insert and snap into place. Do not adhere to Clapboard; you do not want to restrict the movement of the Siding.

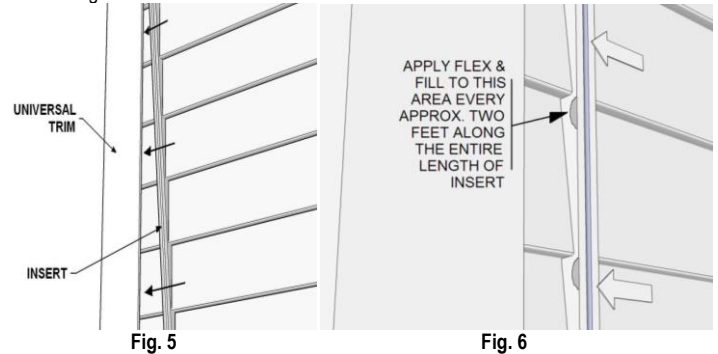

## GENERAL INSTALLATION: WINDOW/DOOR SURROUNDS AND FASCIAS

Properly flash all windows and doors in accordance with local building codes and window/door manufacturer's flashing recommendations.

**Bottoms of windows and fascias** must be trimmed with a rabbeted trimboard or sill (see Fig. 7). The function of this rabbet is to hold the top edge of the clapboard, prevent the course from lifting out of the tongue and groove, and allowing the clapboard to expand and contract without restriction. Never pin the clapboard (e.g. never face-nail, never caulk). Leave a minimum of 1/2" clearance between clapboard ends and any fixed vertical surface. In the case of historical sill treatment, the sill, in addition to the retention rabbet (see Fig. 7) must be rabbeted at the ends to allow the clapboard to expand and contract without restriction.

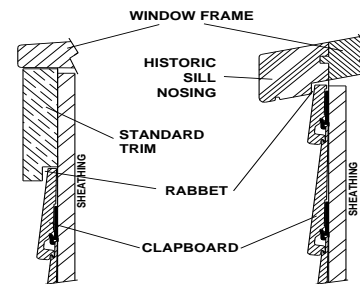

Fig. 7

**Top of windows/doors** must be trimmed with Header Trim (see below). Cut out an expansion channel to match the Universal Trim profile used on the side casings (see Fig. 8). The Header Trim holds the lower edge of the clapboard and allows the clapboard to expand and contract without restriction.

**Installation must follow the instructions in this manual to maintain product warranty.**

**In order to secure your warranty, please visit our website to register your product. [www.nucedar.com/technical/warranty/](http://www.nucedar.com/technical/warranty/)**

**For additional copies and revisions, go to [www.nucedar.com](http://www.nucedar.com).**



**Back View above Window/Door**

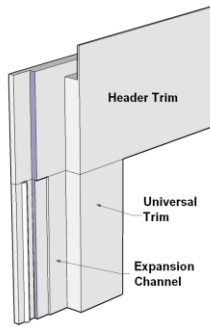

Fig. 8

If the clapboard above the window/door must be notched, cut the clapboard to line up with the milled chalk line mark. Leave 1/8" clearance above the channel in the Header Trim (see Fig. 9).

**Back View above Window/Door**

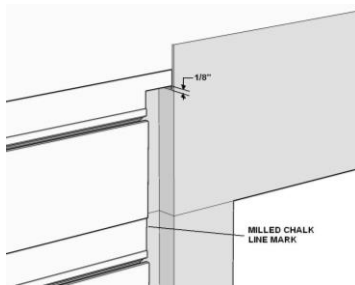

Fig. 9

For light blocks, faucets, downspouts, pipes, etc., leave a minimum of 1/2" clearance between clapboard ends and any fixed vertical surface. Never pin the clapboard (e.g. never face-nail, never caulk). Use Snap-In Insert™ on the sides of light blocks, etc. to create butted appearance.

**TOUCH-UP AND RE-PAINTING**

Apply touch-up paint on all cuts, planed edges and small damaged areas.

NuCedar can be touched up with a high-grade exterior latex paint. NuCedar recommends PPG MANOR HALL® Exterior 100% Acrylic Latex Paint. Take a sample of the product you are trying to match and your local PPG store will color match the touch up paint for you. You may also purchase touch-up paint through NuCedar, just contact your local dealer.

In the future, if you would like to repaint the product, it is possible to do; however, you will void your warranty going forward. For re-painting, use a high-grade exterior latex paint, such as PPG *Manor Hall* (Exterior, Satin Finish). Make sure that your paint color has a Light Reflective Value (LRV) of 55 units or greater.

Prior to touching up or repainting, make sure that the surface area is properly cleaned and prepared according to manufacturer's specifications.

MANOR HALL is a registered trademark of PPG Architectural Finishes, Inc.

**CARE AND MAINTENANCE**

NuCedar products can be safely cleaned using a mixture of water and mild detergent or a mild household cleaner and a cloth. Remove mold/mildew using a mild commercial mold/mildew remover. NuCedar can be lightly sprayed or cleaned with a house brush (high pressure power-washers will destroy the Rough Sawn texture) to remove dust and debris. Refer to manufacturer's instructions.

**GENERAL INSTALLATION: MISC. SIDING PENETRATIONS**  
**SYSTEM COMPONENTS**

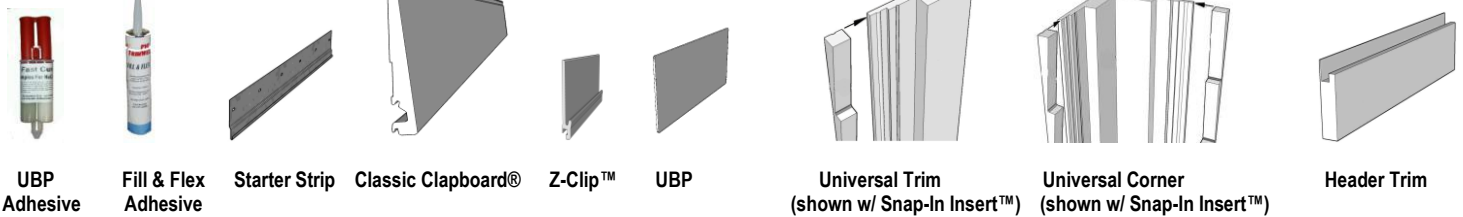

**Installation must follow the instructions in this manual to maintain product warranty.**  
**In order to secure your warranty, please visit our website to register your product. [www.nucedar.com/technical/warranty/](http://www.nucedar.com/technical/warranty/)**  
For additional copies and revisions, go to [www.nucedar.com](http://www.nucedar.com).



# CLASSIC CLAPBOARD® AND TRIM INSTALLATION INSTRUCTIONS

## NuCedar Siding & Color Trim Warranty Registration

In order to secure your warranty, we ask that you please fill out the form below and mail back to us at

NuCedar Mills  
Warranty Registration Department  
1000 Sheridan St  
Chicopee, MA 01022

You may also register online at [www.nucedar.com/technical/warranty/](http://www.nucedar.com/technical/warranty/)

Homeowner Full Name \_\_\_\_\_

Email Address \_\_\_\_\_

Phone Number \_\_\_\_\_

Address \_\_\_\_\_

City & State/Prov/Region, Zip Code \_\_\_\_\_

Country \_\_\_\_\_

Date of Installation \_\_\_\_\_

Type of Material (Shingle, Trim, etc) Color and Texture \_\_\_\_\_

List of Squares of Siding  
and/or Linear Feet of Trim

(You may also just include a packing slip of what was  
sent) \_\_\_\_\_

Dealer Name (Where was the material purchased) \_\_\_\_\_

Dealer Address \_\_\_\_\_

Dealer City, ST/Prov/Region, Zip Code \_\_\_\_\_

Dealer Country \_\_\_\_\_

Contractor Name \_\_\_\_\_

Contractor Phone Number \_\_\_\_\_

*Installation must follow the instructions in this manual to maintain product warranty.*

*In order to secure your warranty, please visit our website to register your product. [www.nucedar.com/technical/warranty/](http://www.nucedar.com/technical/warranty/)*

*For additional copies and revisions, go to [www.nucedar.com](http://www.nucedar.com).*

Protected by Patent No.: US 7,482,038B1 Process for Preparing Siding